

TRAFFIC CONTROL PLAN

ROAD CLOSURE

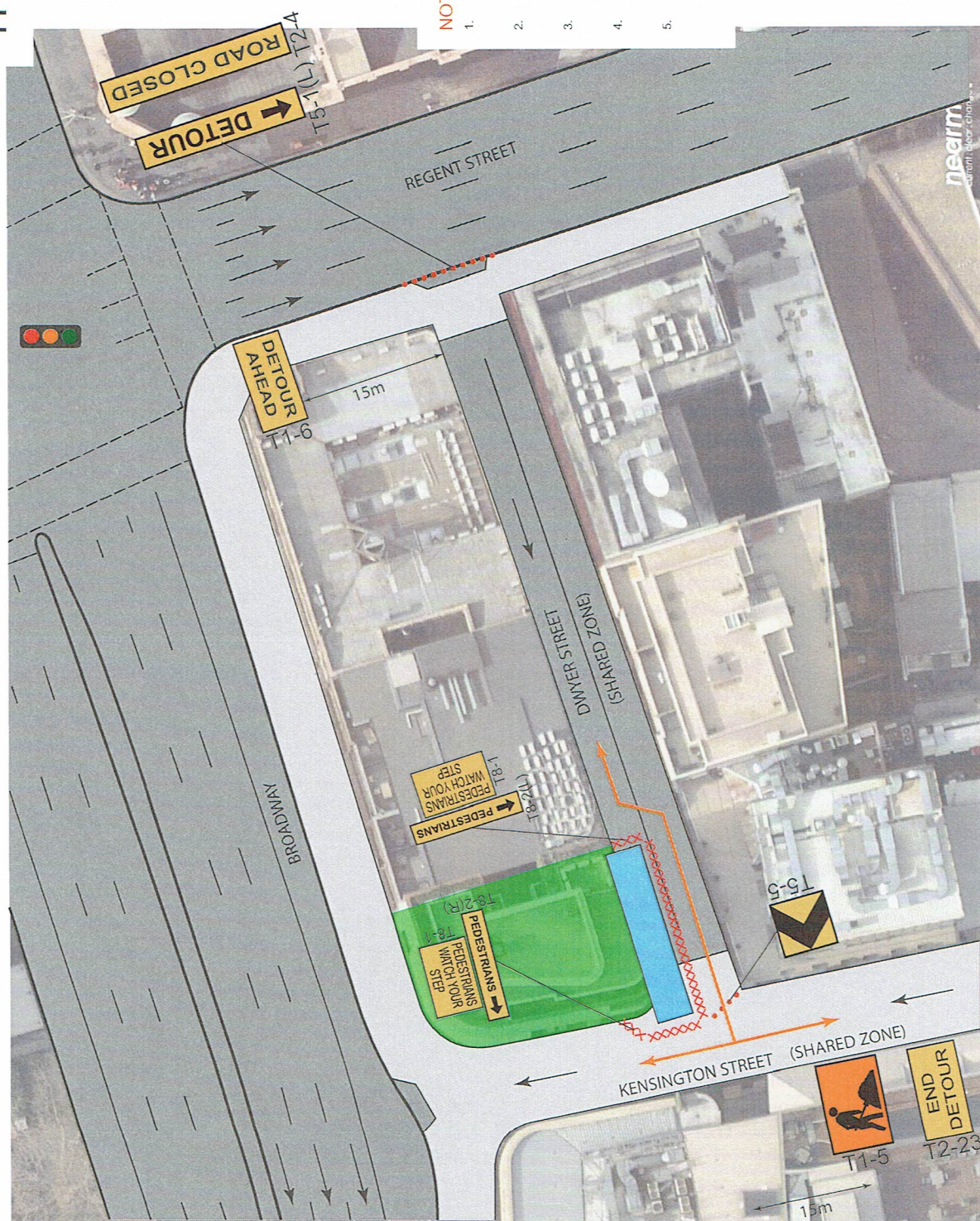

NOTES:

1. ALL SIGNAGE TO BE INSTALLED IN ACCORDANCE WITH RMS "TRAFFIC CONTROL AT WORKSITES" MANUAL AND AS1742.3.
2. ALL SIGNAGE AND DELINEATION MUST BE INSTALLED BY RMS CERTIFIED TRAFFIC CONTROLLER(S) ONLY.
3. EXISTING PEDESTRIAN ACCESS TO SURROUNDING PROPERTIES MAINTAINED AT ALL TIMES.
4. PEDESTRIAN ACCESS ALONG DWYER STREET BETWEEN REGENT ST & KENSINGTON ST TO BE MAINTAINED VIS THE EXISTING SHARED ZONE.
5. VEHICULAR ACCESS TO KENSINGTON STREET FROM REGENT STREET TO USE DETOUR VIA GOULD ST (SEE SBMG01988-13 FOR DETOUR PLAN).

LEGEND:

DELINEATION (i.e. TRAFFIC CONES)

TRAFFIC FLOW

Purpose or use	Approach Speed (km/h)	Max Spacing (m)	Recommended Topir Lengths
<ul style="list-style-type: none"> All purposes on residential or commercial streets Center-line on approach to Traffic Controller position Outer edge of traffic lane - i.e. walking on shoulder 	<50	4	<ul style="list-style-type: none"> Aspaved (km/h) Traffic controller Letter on sign Merge taper
<ul style="list-style-type: none"> 51.70 / > 70 Center line on approach to Traffic Controller position Outer edge of traffic lane - i.e. 2 way road 	51.70 / > 70	18 / 24	<ul style="list-style-type: none"> 46.5 15 30 60
<ul style="list-style-type: none"> Separating opposing traffic on a two lane undivided road 	51.70 / > 70	18 / 24	<ul style="list-style-type: none"> 66.65 N/A 70 115
<ul style="list-style-type: none"> Separating opposing traffic on a multilane undivided road 	51.70 / > 70	9 / 12	<ul style="list-style-type: none"> 76.85 N/A 80 145
<ul style="list-style-type: none"> Adjacent to a closed lane on a multilane road 	51.70 / > 70	12 / 18	<ul style="list-style-type: none"> 86.95 N/A 90 145
<ul style="list-style-type: none"> Street tapers 	51.70 / > 70	24 / 60	<ul style="list-style-type: none"> 96-105 N/A 100 160
<ul style="list-style-type: none"> Inducting flexibility pointed lines 	51.70 / > 70	24 / 60	<ul style="list-style-type: none"> > 105 N/A 110 180

PREPARED BY: MATTHEW YOUNG MANAGER, TRAFFIC MANAGEMENT CERTIFICATE No. 0051718998		DATE	DESCRIPTION
		E	
		D	
		C	
		B	
SIGNED: 		20/11/19	INITIAL SUBMISSION

Project/Event:	MIXED-USE DEVELOPMENT		
Location:	16-18 BROADWAY, CHIPPENDALE NSW		
Client :	EMAG APARTMENTS PTY LTD		
Plan No.	SBMG01988-11	A	Date: 28TH NOVEMBER 2019
SCALE: NOT TO SCALE			

TRAFFIC CONTROL PLAN

ROAD CLOSURE - DETOUR ROUTE

NOTES:

1. ALL SIGNAGE TO BE INSTALLED IN ACCORDANCE WITH RMS "TRAFFIC CONTROL AT WORKSITES" MANUAL AND AS1742.3.
2. ALL SIGNAGE AND DELINEATION MUST BE INSTALLED BY RMS CERTIFIED TRAFFIC CONTROLLER(S) ONLY.
3. DETOUR ROUTE TO BE INSTALLED WITH ASSOCIATED ROAD CLOSURE SEE SBMG01988-12 FOR DETAILS.
4. DETOUR ROUTE PROPOSED FOR VEHICLES ONLY, PEDESTRIAN ACCESS ALONG THE DWYER STREET SHARED ZONE MAINTAINED DURING CLOSURE.

LEGEND:

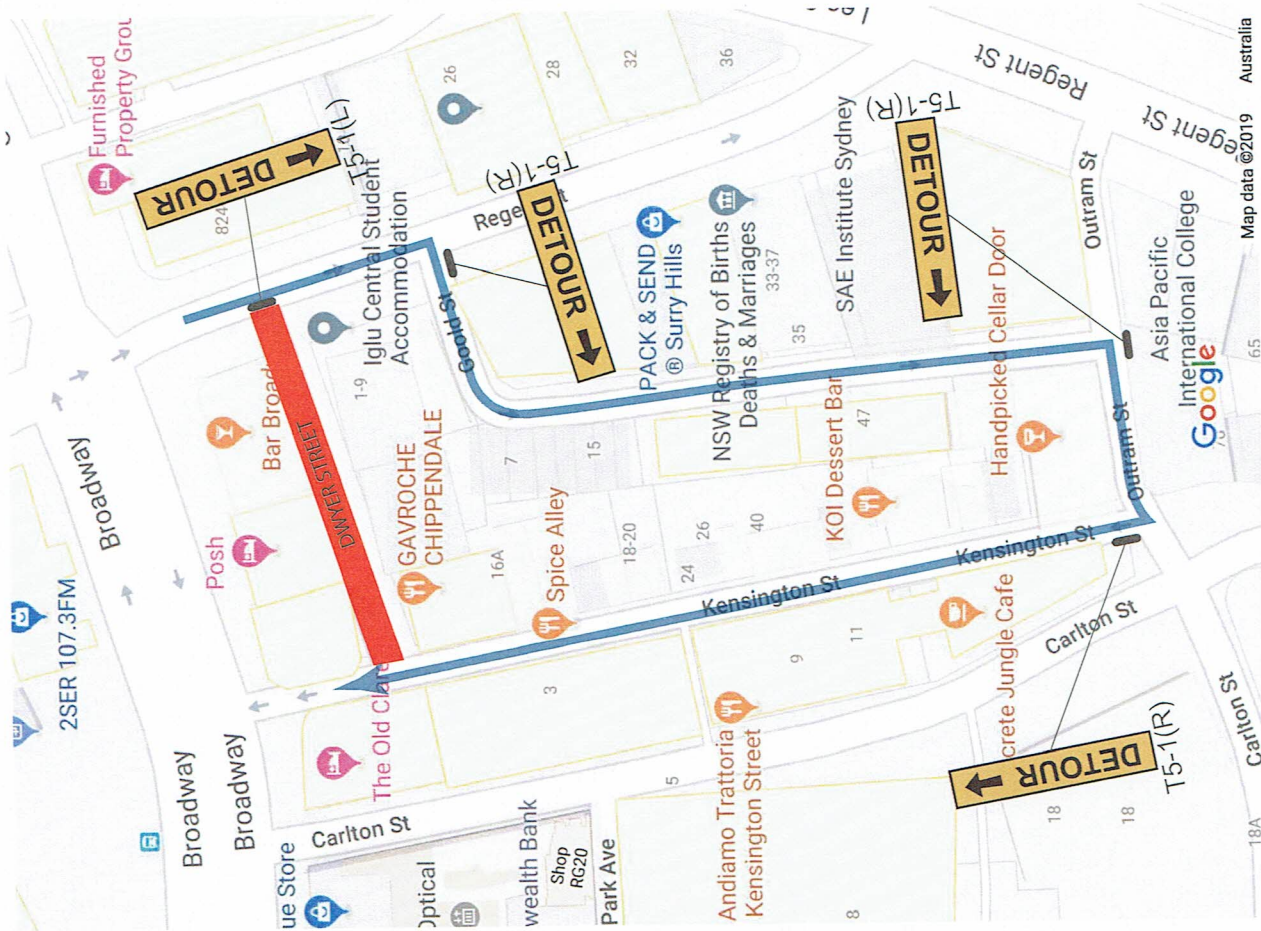

RECOMMENDED MINIMUM SPACING OF CONES AND BARRIERS				RECOMMENDED TAPE LENGTHS			
Purpose an usage	Approach Speed (km/h)	Spacing (m)	Max Spacing (m)	Approach Speed (km/h)	Spacing (m)	Max Spacing (m)	Max Spacing (m)
All purposes on residential or commercial streets	All Cases	< 45	4	All Cases	< 45	15	0
Center line on approach to Traffic Controller position	51-70 / > 70	18 / 24	4	51-70 / > 70	15	15	30
Outer edge of traffic lane - i.e. working on shoulder	51-70 / > 70	12 / 18	4	51-70 / > 70	15	30	60
Separating opposing traffic on a 2-lane 2-way road	51-70 / > 70	18 / 24	4	51-70 / > 70	15	30	60
Separating opposing traffic on a multi-lane undivided road	51-70 / > 70	18 / 24	4	51-70 / > 70	15	30	60
Separating opposing traffic on a multi-lane divided road	51-70 / > 70	18 / 24	4	51-70 / > 70	15	30	60
Adjacent to a closed lane on a multi-lane road	51-70 / > 70	18 / 24	4	51-70 / > 70	15	30	60
Merge lanes	51-70 / > 70	12 / 18	4	51-70 / > 70	15	30	60
Lateral shift tapers	51-70 / > 70	12 / 18	4	51-70 / > 70	15	30	60
Protecting freshly painted lines	51-70 / > 70	24 / 60	4	51-70 / > 70	15	30	60
Protecting freshly painted lines	51-70 / > 70	24 / 60	4	51-70 / > 70	15	30	60

DATE	DESCRIPTION	INITIAL SUBMISSION
20/11/19		A

PREPARED BY MATTHEW YOUNG
RMS PREPARE A WORKZONE
TRAFFIC MANAGEMENT PLAN
CERTIFICATE No. 0651718988

SIGNED:

28TH NOVEMBER 2019

Scale: NOT TO SCALE

Project/Event: MIXED-USE DEVELOPMENT

Location: 16-18 BROADWAY, CHIPPENDALE NSW

Client: EMAG APARTMENTS PTY LTD

Plan No. SBMG01988-13

Date: 28TH NOVEMBER 2019

Scale: NOT TO SCALE

SBMG PLANNING

SBMG Pty Ltd
ABN: 34 167 165 560
www.sbmplanning.com.au
mail@sbmplanning.com.au
m: 0467 370 380

SBMG PLANNING